



Floor Plan Details

2,939 - 2,969 sq. ft. | 4 bedrooms | 3.5 baths | 2-car garage | Plan #5500



ADDITIONAL OPTIONS:

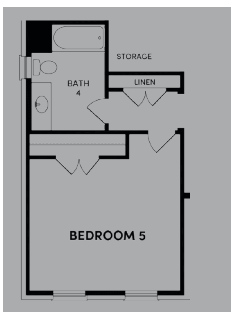

Bedroom 5 / Bath 4



Media Room



Game Room

Brookfield Residential

Hillsdale: Available Elevation Options



TRADITIONAL



MODERN PRAIRIE



MODERN EUROPEAN



[BrookfieldTX.com](https://www.BrookfieldTX.com) | 682-317-0698

Additional structural options are available, contact a new home counselor for details. The total number, layout, design and location of homes; unit mix; and the location, design and layout of recreational facilities may be changed due to a number of circumstances, including governmental requirements and market demand. Dimensions are approximate in nature and are not intended for final reference. Brookfield Residential and its affiliates reserve the right to change homesites, timelines, floor plans and home prices and make modifications in materials and specifications at any time without prior notice. © 2025 Brookfield Residential Properties ULC. All rights reserved. REV. APRIL/2025